

Since 1995, we focus on switches

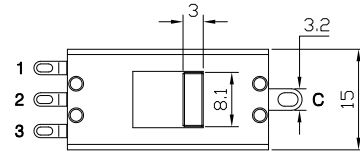

XN-14C-1410-AA1

- Single Pole; 4 Position
- Ratings:
16A 125VAC; 10A 250VAC; UL
16A 125VAC; 10(2)A 250VAC; TUV, CB, CQC
- Features:
Soldering Terminal

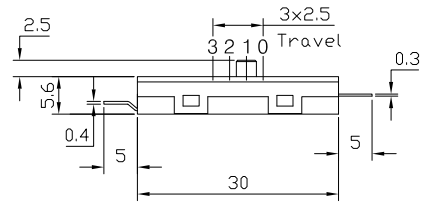

XN-14C- 1 4 1 0 - XXXX

Single Pole Actuator Code
 4 Position Reed Code
 Current at 250VAC Terminal Code

Actuator Options

POSITION	CIRCUIT
0	
1	
2	
3	

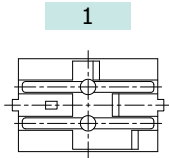

POSITION	CIRCUIT
0	
1	
2	
3	

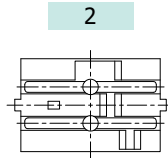

POSITION	CIRCUIT
0	
1	
2	
3	

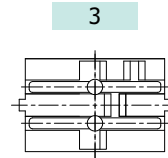

POSITION	CIRCUIT
0	
1	
2	
3	

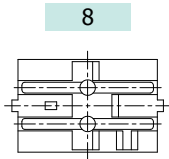

POSITION	CIRCUIT
0	
1	
2	
3	

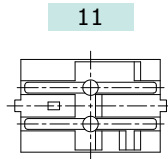

POSITION	CIRCUIT
0	
1	
2	
3	

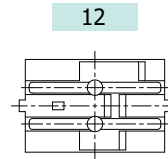

POSITION	CIRCUIT
0	
1	
2	
3	

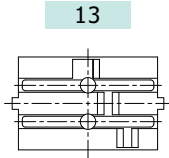

Terminal Options (Outside Dimension)

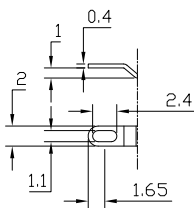

A

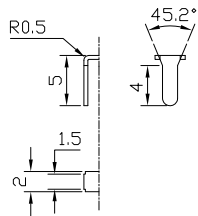

T

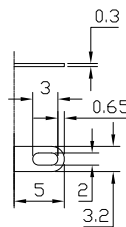

A

Reed Options (Outside Dimension)

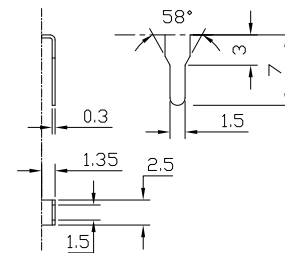

T