

DB-8 系列电源插座

Rating:

5A 250V AC T105  Approval

2.5A 250V AC  Approval

Insulation resistance: 1000MΩ(min)500V DC

Dielectric withstand voltage: 2500V AC 5s Between terminals

DB-8-15P9B

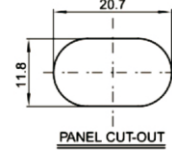
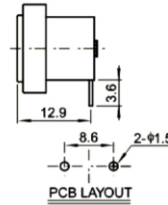
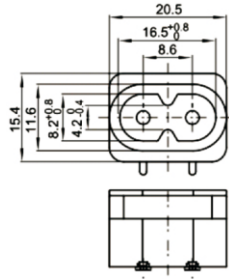

DB-8-16P20

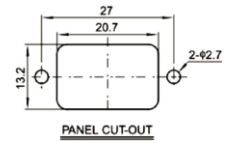
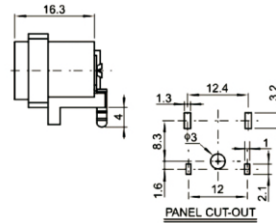
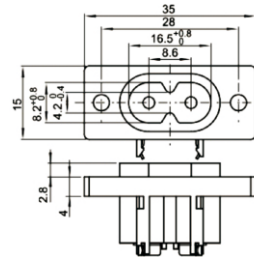

DB-8-17S2B

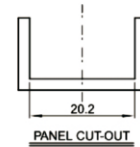
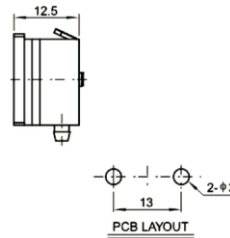
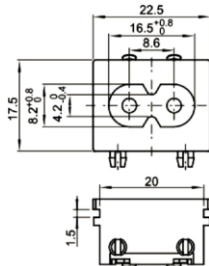
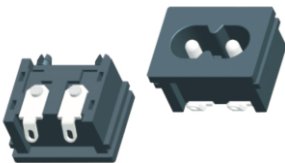

DB-8-D(T)

